

NORTH KENT MALL

Jupiter Ave, Plainfield Twp, MI 49525

LORMAX STERN

FOR
LEASE

AVAILABLE
10,000 SF

LOWE'S

JUPITER AVENUE

PLAINFIELD AVENUE NE

FAMILY
Farm & Home

DOLLAR TREE

Dunham's
SPORTS

PROPERTY DESCRIPTION

- Located at the intersection of Jupiter and Plainfield Avenue, North Kent Mall is well positioned in the super regional trade area of Kent County
- Bordered by I-96 and M-37 and offers 328,000 SF of prime retail space and outlot availability for restaurant use
- The Center is well situated to draw traffic to its active anchors including: Lowe's, Dunham's Sports, Dollar Tree, and Family Farm and Home

PROPERTY SUMMARY

Available SF 10,000 SF

DEMOGRAPHICS	3 MILES	5 MILES	7 MILES
Total Population	43,488	114,524	231,063
Total Households	17,955	47,041	94,056
Average HH Income	\$99,751	\$70,390	\$69,738

CHRIS BROCHERT

(248) 737-7110

cgb@lormaxstern.com

LORMAX STERN

www.lormaxstern.com

NORTH KENT MALL

Jupiter Ave, Plainfield Twp, MI 49525

PLAINFIELD TWP. POSITIONING



WESTERN MICHIGAN LOCATION

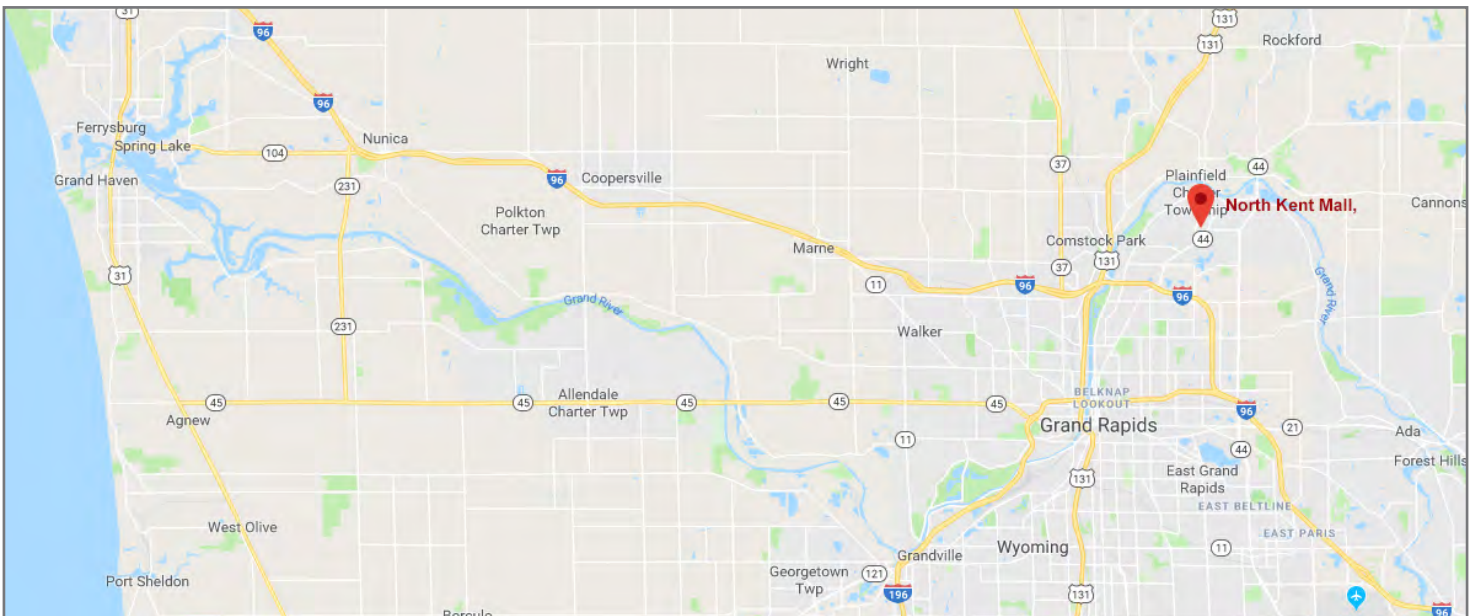

CHRIS BROCHERT

248 737 7110

cgb@lormaxstern.com

LORMAX STERN

www.lormaxstern.com

NORTH KENT MALL

Jupiter Ave, Plainfield Twp, MI 49525

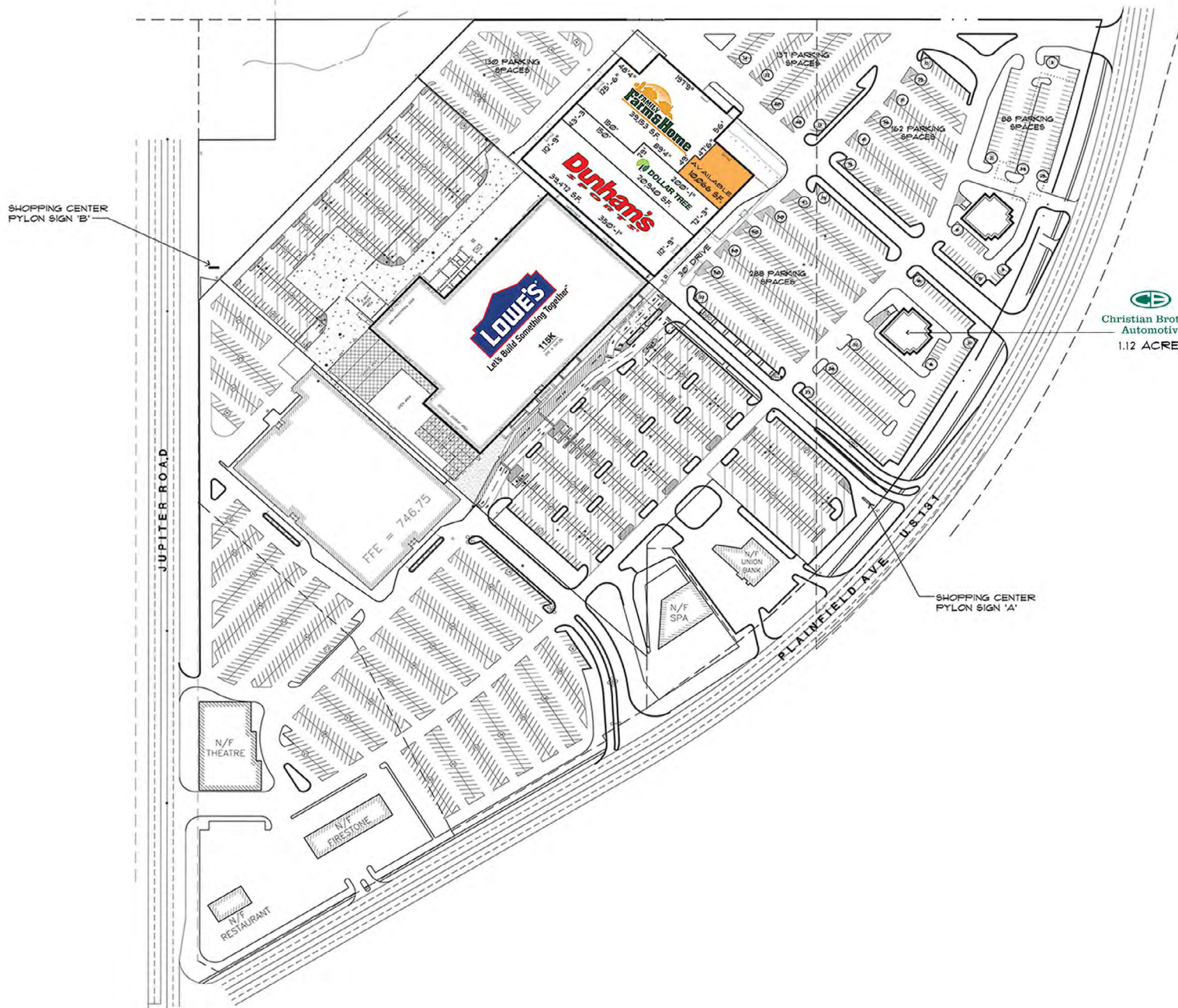

CHRIS BROCHERT

248 737 7110

cgb@lormaxstern.com

LORMAX STERN

www.lormaxstern.com